





1. Permit No. 000040/L.O/Pg/HMDA/2021 dated:30-07-2024 Final layout is released subject to following condition.
2. This approval does not the application of provision of the Urban Land (Ceiling & Regulation) Act, 1973 to the above land
3. This Final Lay out approval does not confer or affect the owner ship boundary is the sole responsibility of the applicant
4. The final Layout as Released subject to the condition. That the External Development of Satellite town ship should be paid to the Owner/Plot holder as and when demanded by Hyderabad Metropolitan Development Authority.
5. This permission does not bar any public agency including HMDA/Local body to acquire the lands of public purpose as per Law.
6. If any dispute litigation arises in future, regarding the ownership of a land, site boundaries etc., the applicant shall responsible for the settlement of the same. HMDA or its employees shall not be a party to any such dispute/litigation and draft approved Layout Plan/ Final layout plan shall be deemed to cancelled without notice and action will be taken as per Law.
7. The applicant is not permitted to construct the compound wall around the site and not to block the roads so as to provide access to the neighboring lands.
8. The applicant / developer any misinterpretation of nay fabricated documents furnished for the taking approval, that approved draft Layout plan / Final Layout plan will be withdrawn and cancelled and action will be taken as per Law.

PLAN SHOWING THE PROPOSED RESIDENTIAL FINAL LAYOUT IN SY NOS 79P, 81P SITUATED AT MANSANPALLE VILLAGE, MAHESWARAM MANDAL, RANGA REDDY DISTRICT, TELANGANA STATE.		
BELONGING TO :-		
AJASRA HOMES PVT.LTD		
DATE : 30-07-2024	SHEET NO.: 01/01	
AREA STATEMENT HMDA		
PROJECT DETAIL :		
Authority : HMDA	Plot Use : Residential	
File Number : 062297/LT/SMD/FLTU6/HMDA/1301/2024	Plot Sub/Use : Residential Bldg	
Application Type : General Proposal	Plot/Neary/Religious/Structure : NA	
Project Type : Open Layout	Land Use Zone : Residential	
Nature of Development : New	Land Sub/Use Zone : Residential zone-1 (urban areas contiguous to growth corridor)	
Location : Extended area of Erstwhile HUDA (HMDA)	Abutting Road Width : 12.19	
Sub/Location : New Areas / Approved Layout Areas	Survey No. : 79P, 81P	
Village Name : Mansanpalle	North : ROAD WIDTH - 12	
Mandal : Maheswaram	South : VACANT LAND	
	East : VACANT LAND	
	West : VACANT LAND	
AREA DETAILS :		SQ.MT.
AREA OF PLOT (Minimum)	(A)	24514.61
NET AREA OF PLOT	(A-Deductions)	24514.61
Amenity Area		0.00
Total		0.00
BALANCE AREA OF PLOT	(A-Deductions)	23900.19
Accessory/Use Area		9.00
Vacant Plot Area		24505.61
LAND USE ANALYSIS		
Plotted Area		14060.58
Road Area		7870.30
Organized open space/park Area/Utility Area		1969.31
Social Infrastructure Area		614.42
BUILT UP AREA CHECK		
MORTGAGE AREA		0.00
ADDITIONAL MORTGAGE AREA		0.00
ARCH / ENGG / SUPERVISOR (Regd)		Owner
DEVELOPMENT AUTHORITY		LOCAL BODY
COLOR INDEX		
PLOT BOUNDARY		
ABUTTING ROAD		
PROPOSED CONSTRUCTION		
COMMON PLOT		

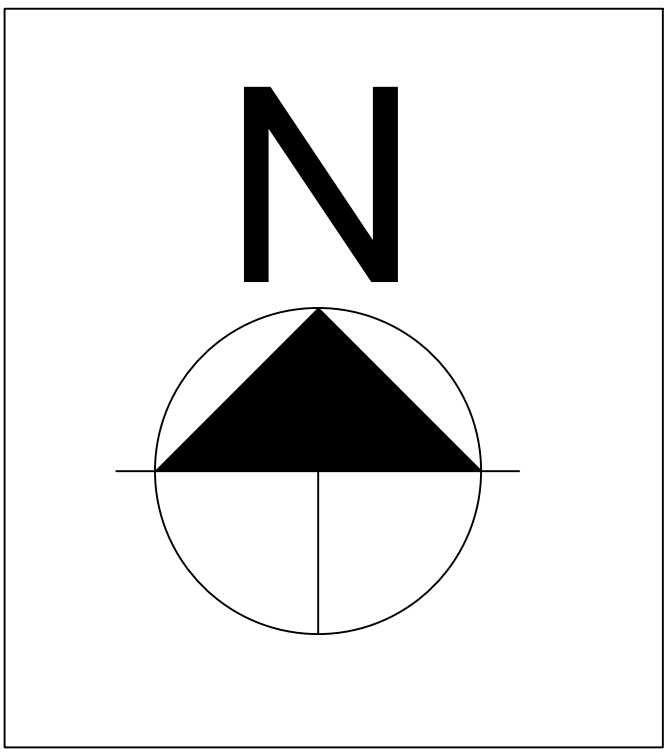

REFERENCE:-

- AVENUE PLANTATION
- MANHOLE
- HARVESTING PIT
- ELECTRIC POLE
- FOOTPATH LINE
- SEWAGE LINE
- WATER LINE
- ELECTRICAL LINE
- TRANSFORMER
- PANEL BOX
- SUMP
- SEPTIC TANK

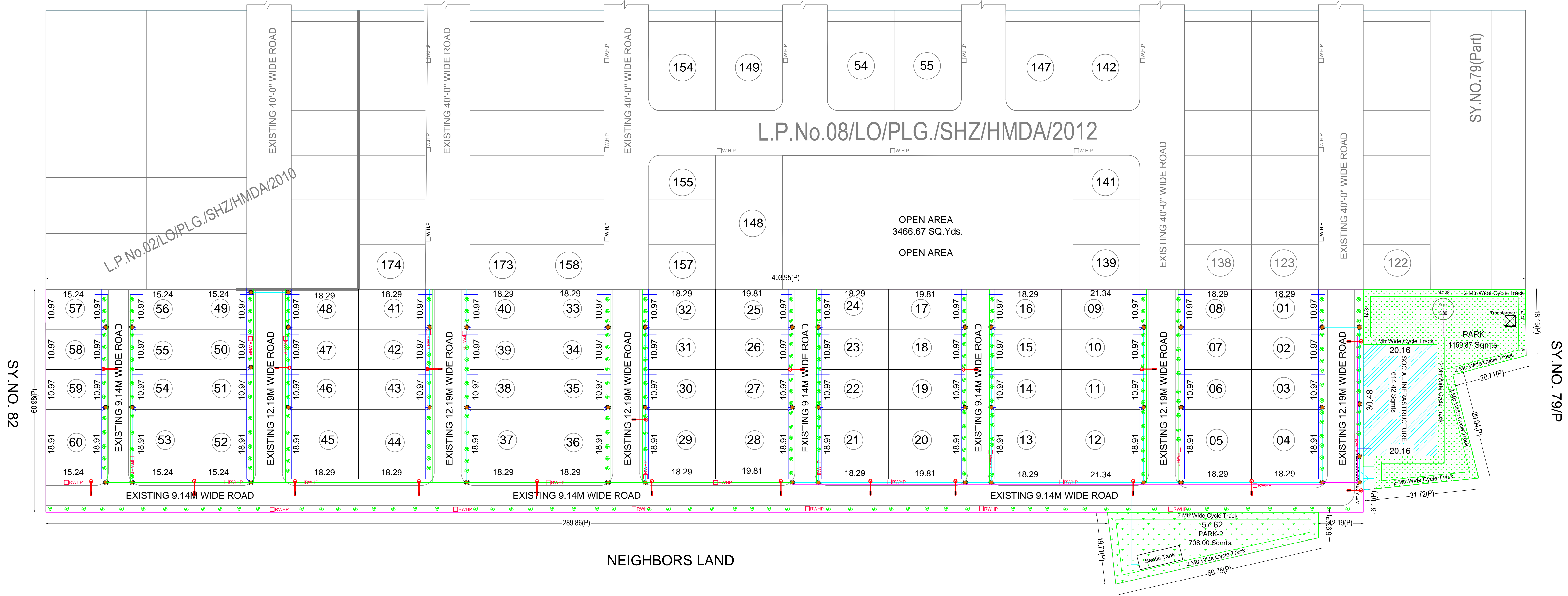

FINAL LAYOUT
(SCALE 1:500)

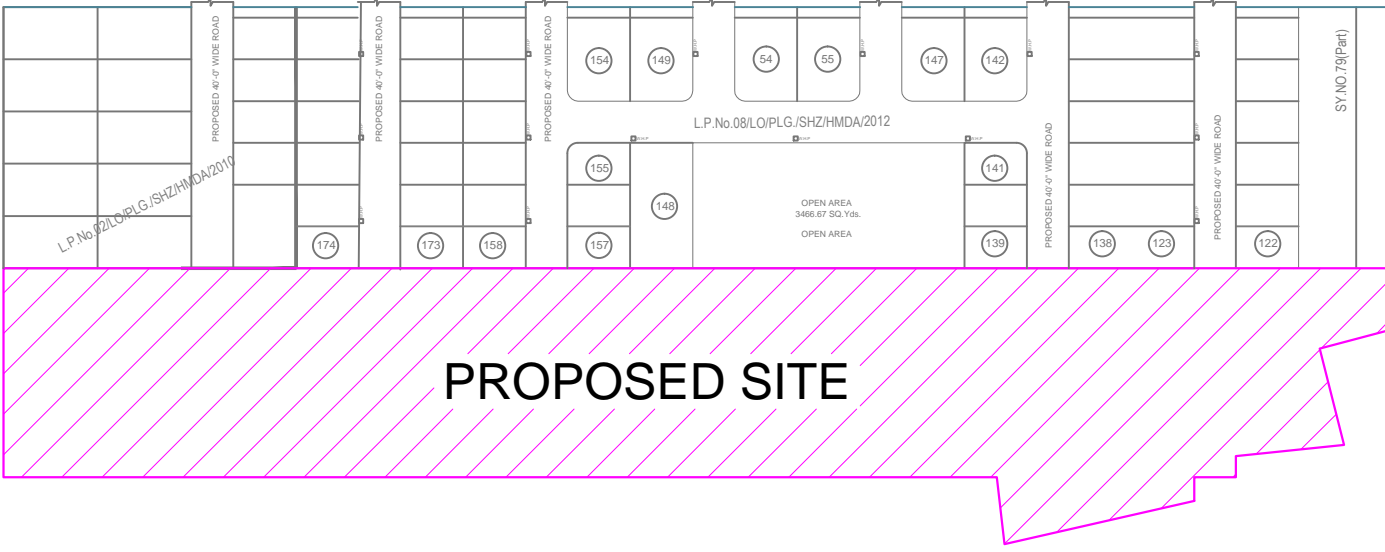

LOCATION PLAN
NOT TO SCALE